

Guardian™ Lint Cleaner

The Guardian™ Long-Staple Lint Cleaner combines the cleaning principles most favored by the textile industry as best preserving the quality of the fiber.

- Cleans, combs, and blends the fiber
- Produces clean, smooth lint with the least harm to the delicate cotton fiber
- Combines efficient combing with gentle air cleaning

Condenser

The lint cleaner is normally fed by a rotary drum condenser, which separates the conveying air from the lint. The batt of cotton produced by the condenser is doffed down into the feedworks by two doffing rollers.

Feedworks

The auxiliary roller in the feedworks guides the batt down between the fluted main feed roller and the feed plate. The cotton feeds through the narrow gap between the feed roller and the feed plate, then it reverses direction around the toe of the feed plate to the cylinder.

Beater Cylinder

The beater cylinder has three pairs of wooden lags with sharp, angled pins, which comb and clean the cotton. The individual fibers are released by the feed roller at different times, creating the combing action which opens and blends the fiber. Entangled trash is released.

Fiber is carried by the cylinder over a series of eight adjustable grid bars, and a wash of air from a trash fan removes the trash without re-contaminating the cotton.

Super-Jet® Section

As air carries the cotton into the Super-Jet® section of the cleaner, a booster fan accelerates the lint, which is forced around a sharp turn past an adjustable slot on the outside of the turn. The denser sand and pin trash are forced out through the slot by their own momentum as the lint is carried past. The lint is then discharged to another cleaner or a battery condenser.

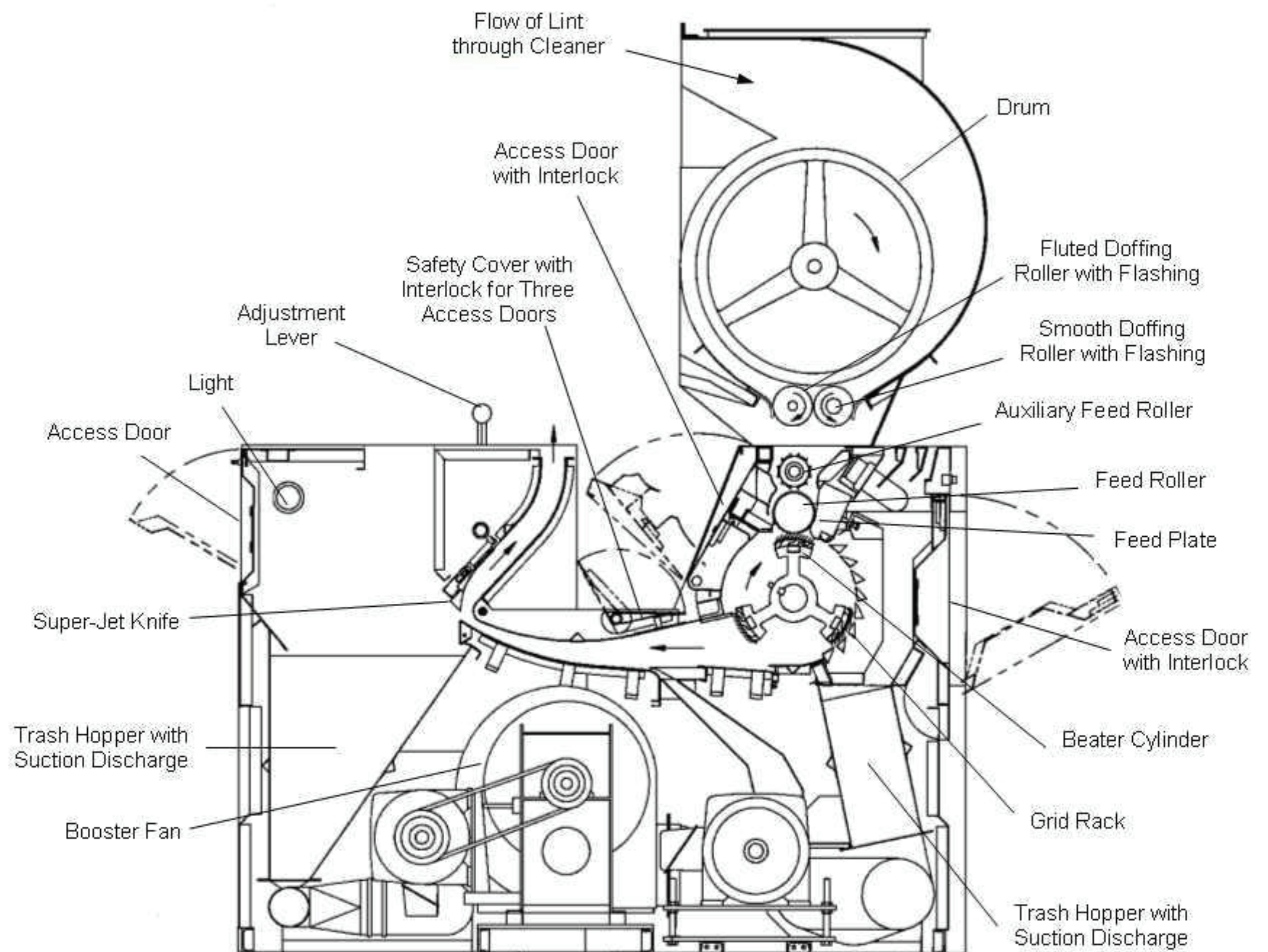

Physical Address: 225 Bourne Boulevard • Savannah, Georgia 31408-9586 USA
Mailing Address: P. O. Box 929 • Pooler, Georgia 31322-0929 USA
Phone: (912) 447-9000 • Fax: (912) 447-9250
Toll Free (USA Only): 1-800-4LUMMUS (1-800-458-6687)
Web Site: www.lummus.com • E-mail: lummus.sales@lummus.com



Lummus products described or listed in this publication are illustrative only. Application and use of these products must be in accordance with the applicable codes and regulations and must be arranged and/or provided with covers and other guards where necessary to assure the safety of personnel. Lummus engineers continue to make improvements. All designs, specifications, and ratings are subject to change without notice.

©Copyright 2020 Lummus Ag Technology